

MAJESTY  YACHTS



MAJESTY 62

[www.majesty-yachts.com](http://www.majesty-yachts.com) | [contact@majesty-yachts.com](mailto:contact@majesty-yachts.com)



The Majesty 62's sleek profile conceals the skillful design of her decks, which include saloon and dining space, 4 guest cabins, 3 heads and separate accommodation for the crew. The fly-bridge is designed to maximize outside space making this the perfect choice for leisure cruising. The elegance of her design continues into the sleeping quarters, with the owner's cabin being situated mid ship allowing large windows to bring the feel of light and space to the lower deck.













## TECHNICAL SPECS

Length Overall  
**61 ft 6 in (18.78 m)**

Beam  
**16 ft 3 in (4.97 m)**

Draft  
**4 ft 11 in (1.49 m)**

Gross Tonnage  
**50 GT**

Displacement  
**35 t approx.**

Fuel Capacity  
**1,003 US gal (3,796 l)**

Fresh Water Capacity  
**150 US gal (567 l)**

Black Water Capacity  
**64.8 US gal (246 l)**

Grey Water Capacity  
**20 US gal (76 l)**

Top Speed  
**25 knots \***

Cruising Speed @ 80 % MCR  
**18 knots\***

Range @ 12 knots  
**400 NM\***

Generators  
**28kW, 230V AC, 50 Hz**

Engines  
**Twin MAN i6-800, 800 HP\*\***

Cabins  
**4 Guest | 1 Crew**

\*Speed depends on engine option, hull cleanliness & sea conditions

\*\*Other options available

# DECK PLANS

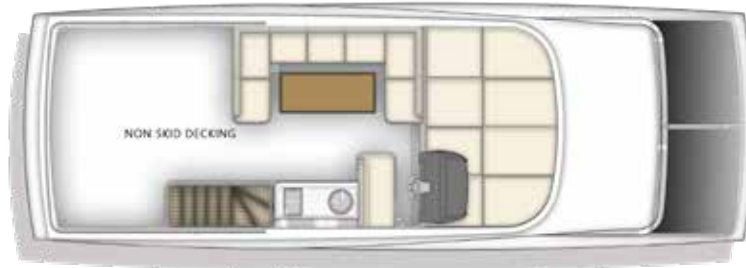

FLY-BRIDGE



MAIN DECK



LOWER DECK